



ASSEMBLY INSTRUCTIONS

Description: Manhattan Accent Chair

Important safety instructions :

- Please read carefully all instructions before assembling.
- For your safety and ease, assembly by two or more adults is recommended.
- Keep instructions for future use.

Pre-assembly:

- Do not discard any content until assembly is complete to avoid accidentally discarding small parts or hardware.
- Take out all parts and hardware from box.

Parts List

Item	Description	QTY
P1	Legs	2
P2	Support Bar	1
P3	Support Bar	1
P4	Chair	1

Hardware List

Item	Description	QTY
H1	Allen Wrench 1/4"	1
H2	Bolts φ1/4"×5/8	12
H3	Flat Washer φ1/4"	12
H4	Allen Wrench 5/16"	1
H5	Bolts φ5/16"×1-1/4"	6
H6	Lock Washers φ5/16"	6
H7	Flat Washer φ5/16"	6

DISCLAIMER:

WHEN PROPERLY ASSEMBLED, THIS ITEM IS SAFE FOR INTENDED USE. SELLER IS NOT LIABLE FOR ANY DAMAGES RESULTING FROM ITEM BEING IMPROPERLY ASSEMBLED AFTER PURCHASE.

Assembly Procedures:

Step 1. Assemble the chair on a flat, soft surface such as carpet or cloth to prevent scratching. Insert support bar(P2)(P3) to the legs(P1). Using allen wrench(H1) to tighten bolts (H2), flat washers(H3) as illustration below

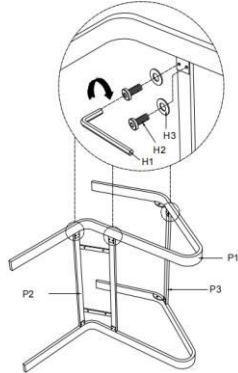

Step 2. Using bolts (H5), lock washers (H6), flat washers (H7), attach legs (P1) to chair (P4). Tighten bolts (H5) with allen wrench (H4) as illustration below.

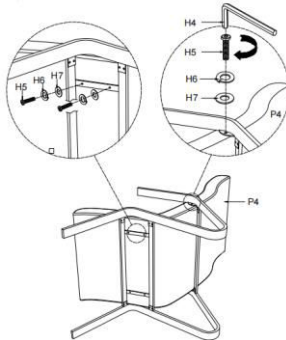

Step 3. Place the chair upright on a level surface. Assembly is complete.



ADDITIONAL NOTE ABOUT SAFETY: BOLTS MAY LOOSEN DURING NORMAL EVERYDAY USE. THEY SHOULD BE PERIODICALLY INSPECTED AND RE-TIGHTENED TO PREVENT DAMAGE OR INJURY. ALWAYS CHECK TO ENSURE THAT ALL HARDWARE IS KEPT TIGHTENED.