

KOHL'S INSPECTION FORM

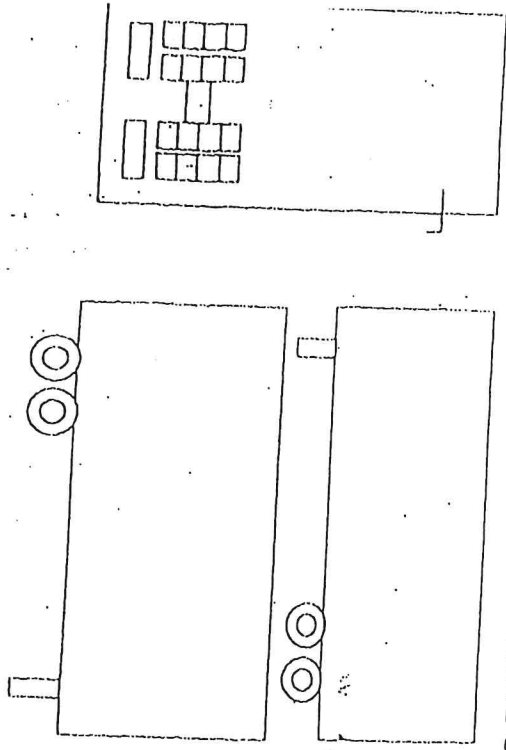

- KEY / CODE
- 1. DENTED
 - 2. SCRATCHED
 - 3. TORN
 - 4. HOLE
 - 5. BROKEN
 - 6. MISSING
 - 7. BENT
 - 8. CRACKED
 - 9. FLAT TIRE
 - 10. BALD TIRE
 - 11. LEAKING AIR
 - 12. LICENSE PLATE-MISSING
 - 13. TAGS EXPIRED
 - 14. DOT INSPECTION TAG
 - 15. MUD FLAPS
 - 16. OTHER

PLEASE ADVISE DISPATCH/SAFETY IF MAJOR DAMAGE IS NOTED ON ANY TRAILER

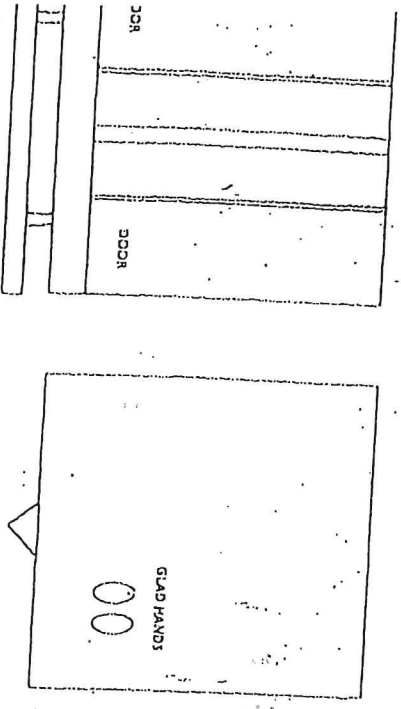

BACK OF TRAILER

FRONT OF TRAILER

KEY CODE#



EMPTY



LOADED



DRIVER NAME: Angel Hernandez

DRIVERS SIGNATURE: [Signature]

DATE: 10-9-19 TIME OUT: _____ TIME IN: 9:20

COMPANY NAME: prestige

CONTAINER NUMBER: TN4293862

SEAL NUMBER: G7100570

DESTINATION: Ge

JARD SIGNATURE:

[Signature]

PRINT NAME:

Jamasia Swinsun

KHREC01

BATCH: 554

KOHL'S RECEIPTS AUTO CREATE
CONTAINER: TTNU4293862

23:50:18 10/09/19
PAGE: 1

RECEIPT #	D/C #	D/C NAME	P/O #	P/O QTY	SHIPPER	WEIGHT
8604462	00810	KOHL'S DC 810	12417926	603	E & E CO LTD	6,030
8604463	00830	KOHL'S DC 830	12417926	461	E & E CO LTD	4,610
8604464	00840	KOHL'S DC 840	12417926	286	E & E CO LTD	2,860
8604465	00855	KOHL'S DC 855	12417926	239	E & E CO LTD	2,390
8604466	00860	KOHL'S DC 860	12417926	198	E & E CO LTD	1,980
8604467	00865	KOHL'S DC 865	12417926	518	E & E CO LTD	5,180
8604468	00875	KOHL'S DC 875	12417926	348	E & E CO LTD	3,480
8604469	00885	KOHL'S DC 885	12417926	168	E & E CO LTD	1,680
8604470	00890	KOHL'S DC 890	12417926	512	E & E CO LTD	5,120
SUB TOTAL:				3,333		33,330

COUNT: 9

3,333

33,330
